



HOMESTEAD COLLECTION

The Palmer

2 - 4 BEDROOMS • 2.5 BATHS • 1,776+ SQ. FT. • 2 - 3 CAR GARAGE



Craftsman

The Palmer

Floor Plan Features:

- 2 - 4 Bedrooms
- 2.5 Baths
- 1,776+ sq. ft.
- 2 - 3 Car Garage

Level 1 Options:

- Fireplace, Den (In Lieu of Bedroom 2), Dining Room (In Lieu of Bedroom 4),
- Optional Walk-In Pantry (In Lieu of Half Bath), Extended Dinette (eliminates
- Covered Deck), 2FT Owners Suite Extension, Deluxe Owners Bath with
- Soaking Tub, 2FT, 4FT, 6FT Garage Extension, 3 Car Garage

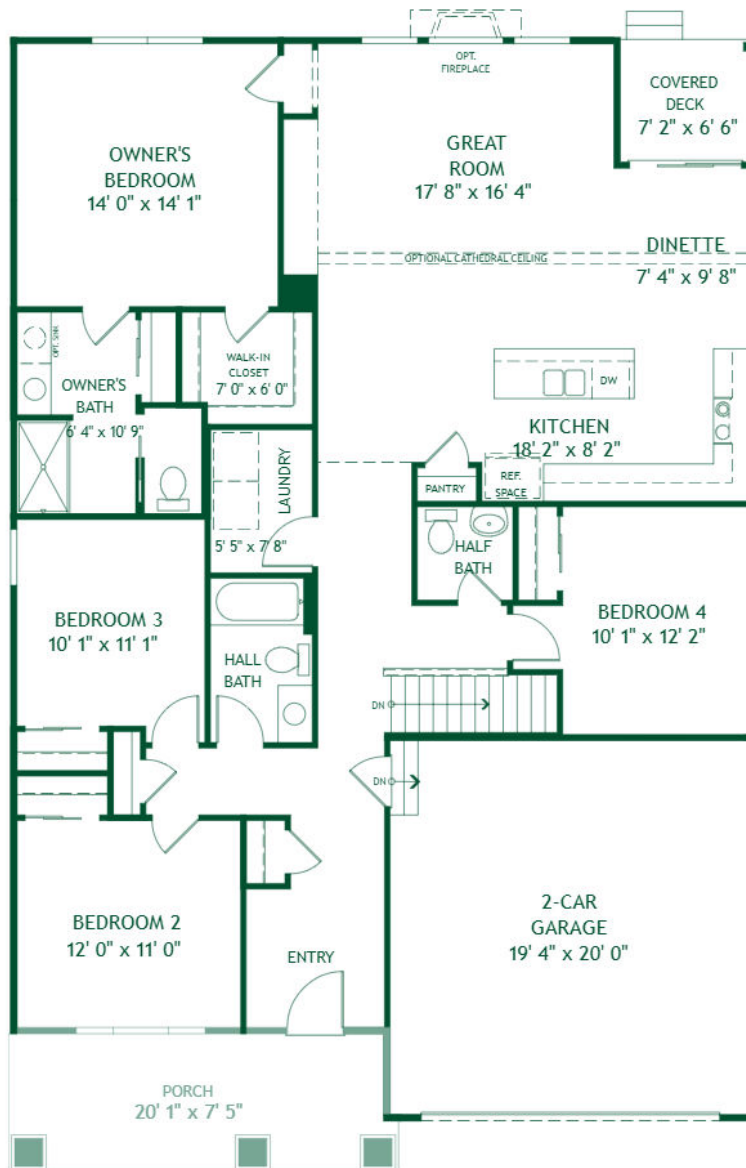

CRAFTSMAN
FIRST FLOOR - BASE PLAN

For our Interactive Floor Plan, please visit: <https://rockfordhomes.com/new-home-designs/palmer>



HOMESTEAD COLLECTION

The Palmer

Floor Plan Features:

- 2 - 4 Bedrooms
- 2.5 Baths
- 1,776+ sq. ft.
- 2 - 3 Car Garage

Basement Level Options:

Three Quarter Basement, Full Basement

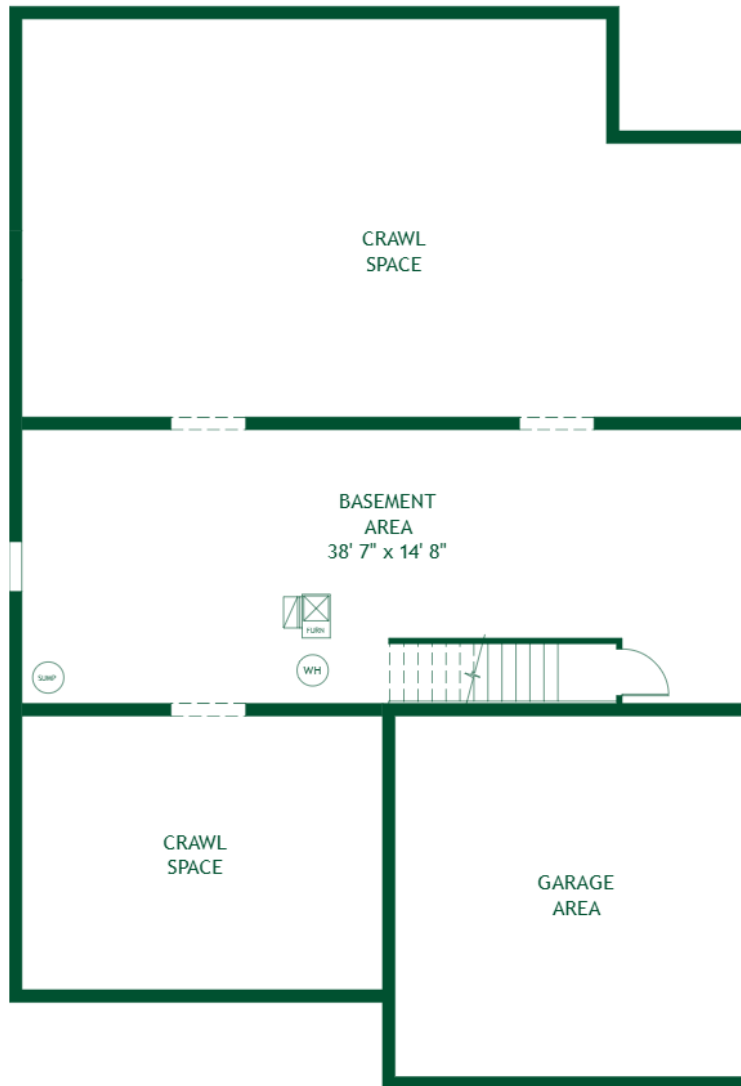

CRAFTSMAN
STANDARD BASEMENT - BASE PLAN

For our Interactive Floor Plan, please visit: <https://rockfordhomes.com/new-home-designs/palmer>

Copyright 2026. Plans, specifications, features, square footages, room dimensions, pricing, and other elements are subject to change without notice or obligation. Elevations may show options that are not included in base pricing. Basement level options and configurations available upon request. All images are artist's conception. Dimensions are estimates based on conceptual architectural plans.



HOMESTEAD COLLECTION

The Palmer

2 - 4 BEDROOMS • 2.5 BATHS • 1,776+ SQ. FT. • 2 - 3 CAR GARAGE

EXTERIOR DESIGNS



American Classic



Craftsman



American Farmhouse

**Rockford Homes
Corporate Office**
999 Polaris Parkway - Suite 200
Columbus, OH 43240



Scan this **QR code** to view
our Interactive Floor Plan
RockfordHomes.com
614-785-0015

